

ANTRIM COUNTY BUILDING DEPARTMENT

GARAGE PLANS & SPECIFICATIONS REFERENCE (Page 1 of 3)

SPECIFICATIONS – ADDITIONAL INFORMATION MAY BE REQUIRED (ONE STORY ONLY)

1. Owner, Or Applicant: _____ Permit #: _____
 2. Site address: _____ Date: _____
 3. Type of Structure: Frame _____ Concrete Block _____ Other _____
 4. Dimensions: Length _____ Width _____ Wall Height _____
 5. Soil classification: _____ Soil bearing: _____ Psf
 6. Footing Size: Depth _____ Width: _____ Thickness _____
 7. Treated Sill: _____ (Necessary if within 8" of open Earth).
 8. Anchor Bolts: Size _____ Spacing: _____
 9. Size of Studs: _____ Spacing: _____
 10. Type of Sheathing: _____ Thickness: _____
 11. Type of Siding: _____
 12. Wind Bracing: _____ Type: _____
 13. Drip Edge: _____
 14. Roof Sheathing: _____ Thickness: _____ Span Rating: _____
 15. Roof Material: _____ Ice/water Shield Width: _____
 16. Ground Snow Loading: **70 PSF Required.**
Truss Length: _____ Spacing: _____ O.C.
- **Keep Certification For The Trusses On Site For Rough Inspection**
-

17. If No Trusses Are Used – Complete the Following:

- 17a. Rafters: Size: _____ Spacing: _____ Grade: _____
 - 17b. Ceiling Joists: Size: _____ Spacing: _____ Grade: _____
 18. Garage Door Opening, Clear Span: _____
Location of Door: Bearing Wall 18a. _____ Gable end 18b. _____
 19. Garage Door Header: Size: _____ Species: _____ Grade _____
 20. All headers greater than 10 ft. shall be pre-manufactured headers
- ❖ See Second Sheet for Corresponding Numbers Indicating Location of Materials

ANTRIM COUNTY BUILDING DEPARTMENT
GARAGE PLAN SPECIFICATIONS (Page 2 OF 3)

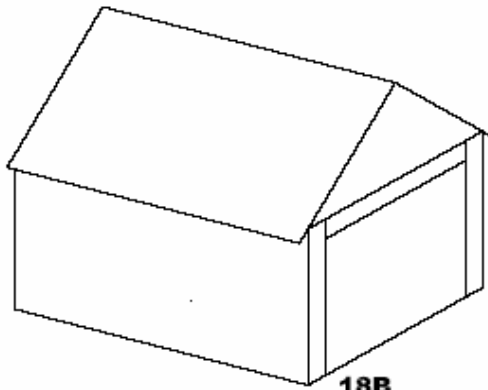

18B

Gable End Header

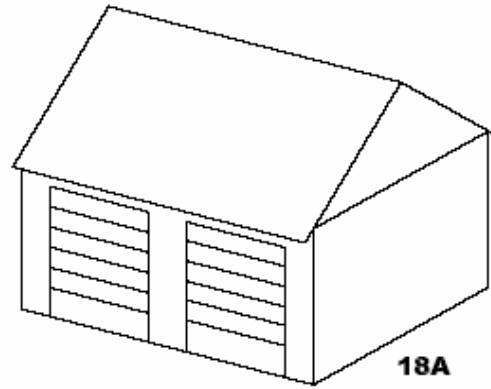

18A

Bearing Wall Header

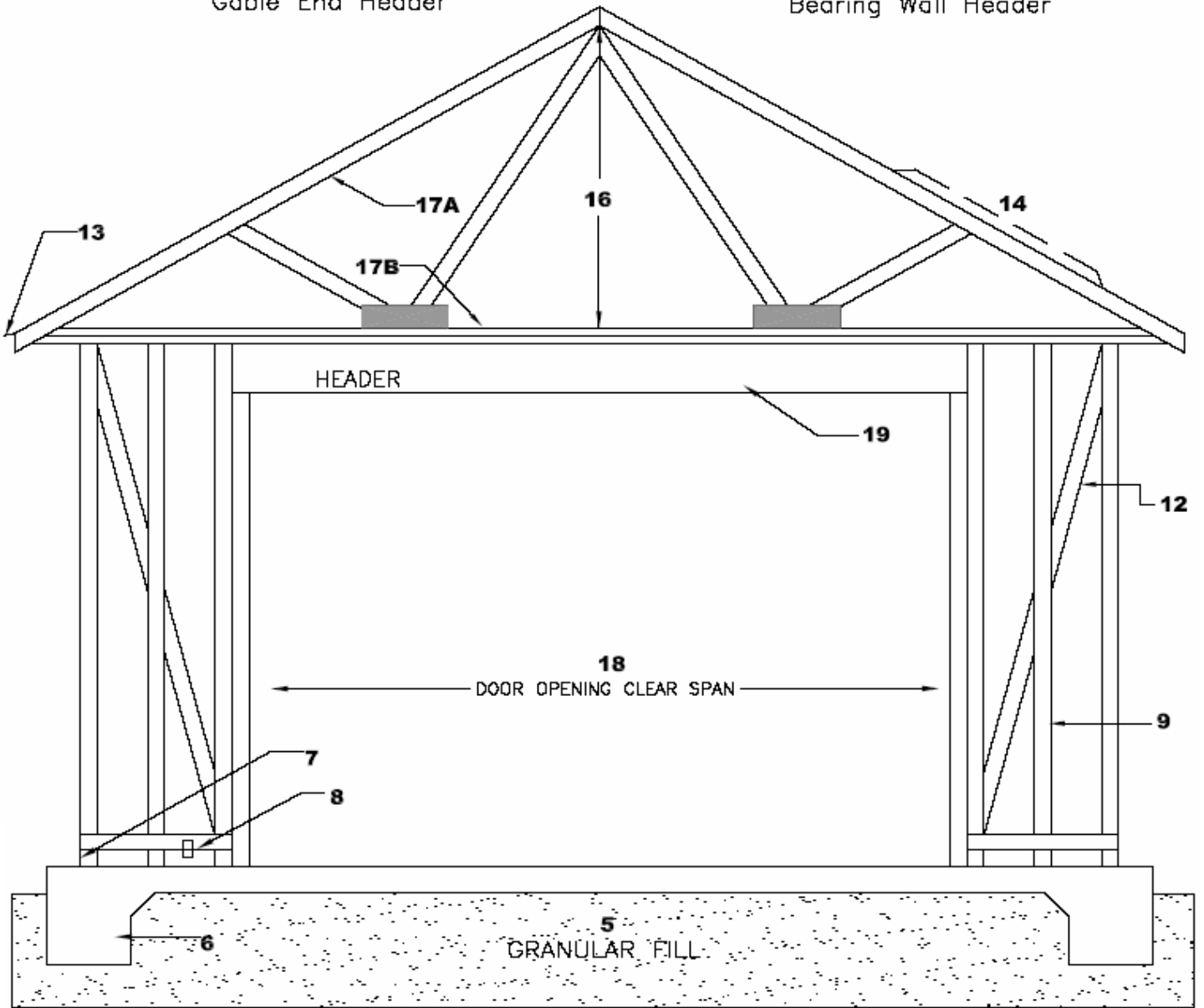

Note - wall bracing under 4' will require alternate bracing and inspection before covered up.

**ANTRIM COUNTY BUILDING DEPARTMENT
GARAGE PLANS & SPECIFICATIONS REFERENCE
GARAGE FOOTING DETAILS (PAGE 3 OF 3)**

MONOLITHIC SLAB

*ANCHOR BOLTS: A MINIMUM OF 1/2" DIAMETER, EMBEDDED IN FOUNDATIONS A MINIMUM OF 7 INCHES.

BOLTS MUST BE LOCATED WITHIN 12" OF CORNERS AND PIERS, AND A MAXIMUM OF 6' ON CENTER. APPROVED ANCHOR CLIPS, OR STRAPS. MAY BE USED IF INSTALLED PER SECTION R403.1.6

**SILLS:
SEE NOTE BELOW
CONCERNING DECAY
PROTECTION

*SEE NOTICE REGARDING ANCHOR BOLTS

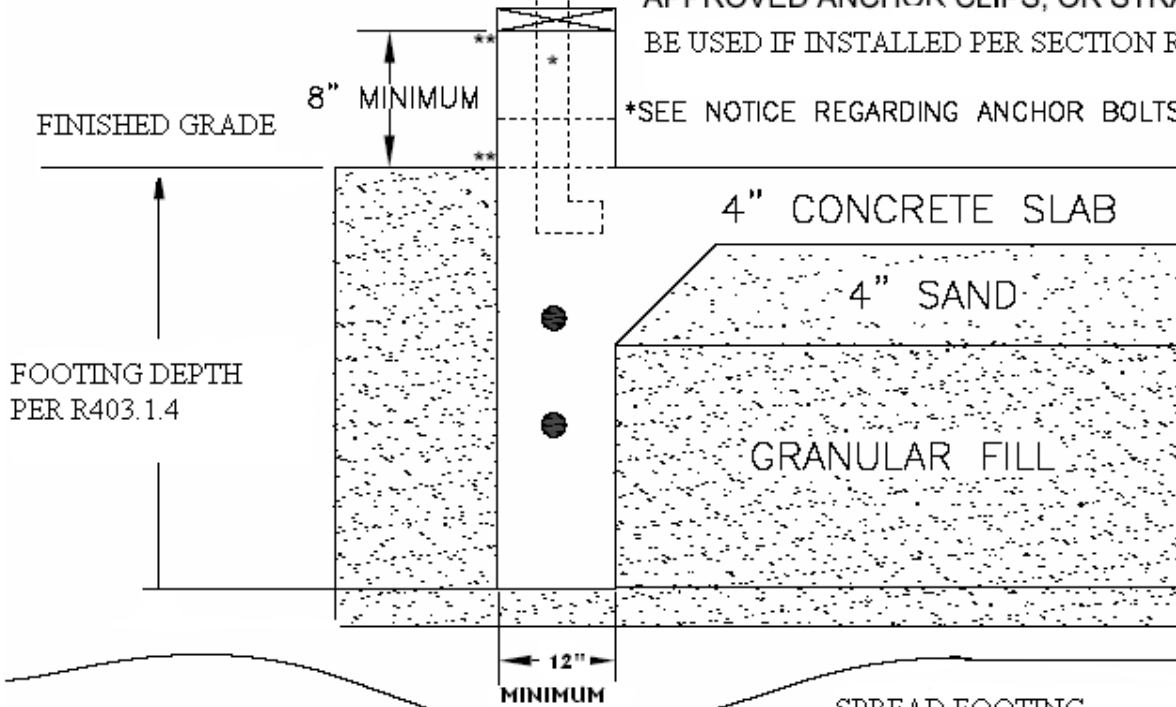

SPREAD FOOTING

ANCHOR BOLT

*REVIEW ANCHOR BOLT NOTICE ABOVE

****DECAY PROTECTION REQUIREMENTS**

ONE & TWO FAMILY - MICHIGAN
RESIDENTIAL CODE 2006
SECTION R319.1
ALL WOOD SILLS, JOISTS, ETC.
WITHIN 8" OF EARTH SHALL BE
OF APPROVED TREATED
MATERIAL.

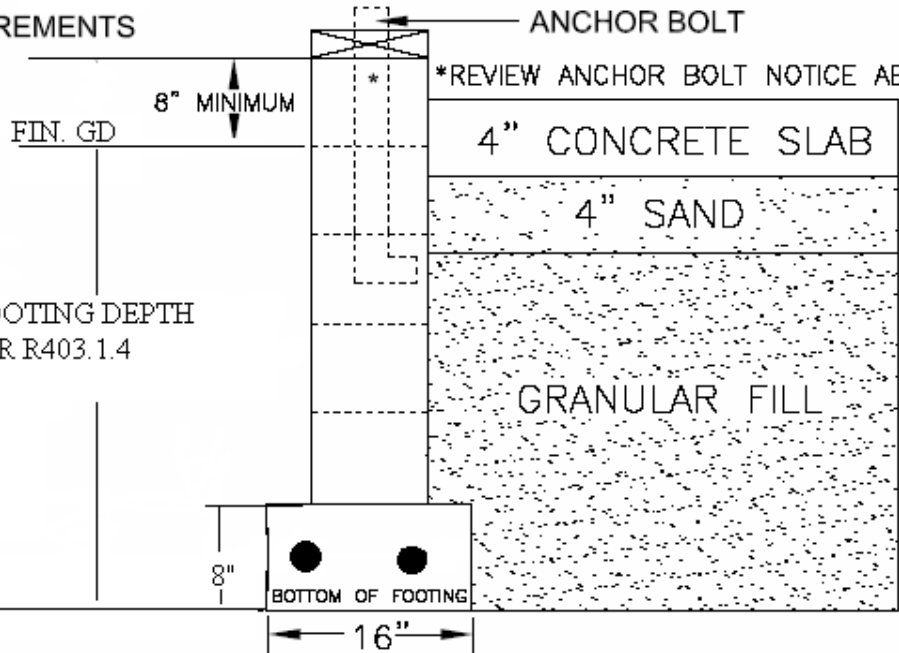

WOOD SIDING: WITHIN 6" OF
EARTH SHALL ALSO BE OF
APPROVED TREATED
MATERIAL. R319.1

